

6 Keyboard assignments

EPCwin is mainly operated via the keyboard. This allows users - with a little practice - a fast and efficient workflow.

To help you get started, here is an overview of the possible key assignments as well as the most important shortcuts.

The computer mouse

A right mouse click has the same function as the Enter key. With the left mouse button, objects can be selected as usual. If the mouse wheel is pressed, previously selected objects are dropped back in their original position.

Toolbar

The options in the toolbar can only be activated via the respective function keys [F1] to [F12] on the keyboard. Alternatively, they can also be selected on the numeric pad of the keyboard.

Please note that depending on the active option, the function keys may be assigned differently!

The quick dial

To enable a quicker selection of an option in dialogues, there is a quick dial field. It is activated immediately each time a dialogue is opened. The number or combination of numbers in front of the button must be entered to use it. A separate confirmation is not necessary.

The Shortcuts

The shortcuts are necessary to operate the software successfully. In some cases there are also combinations possible.

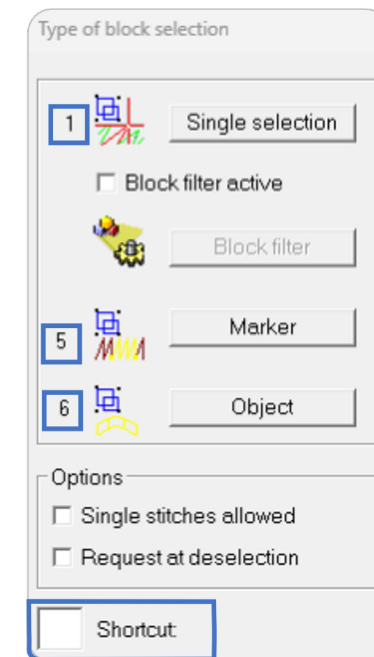

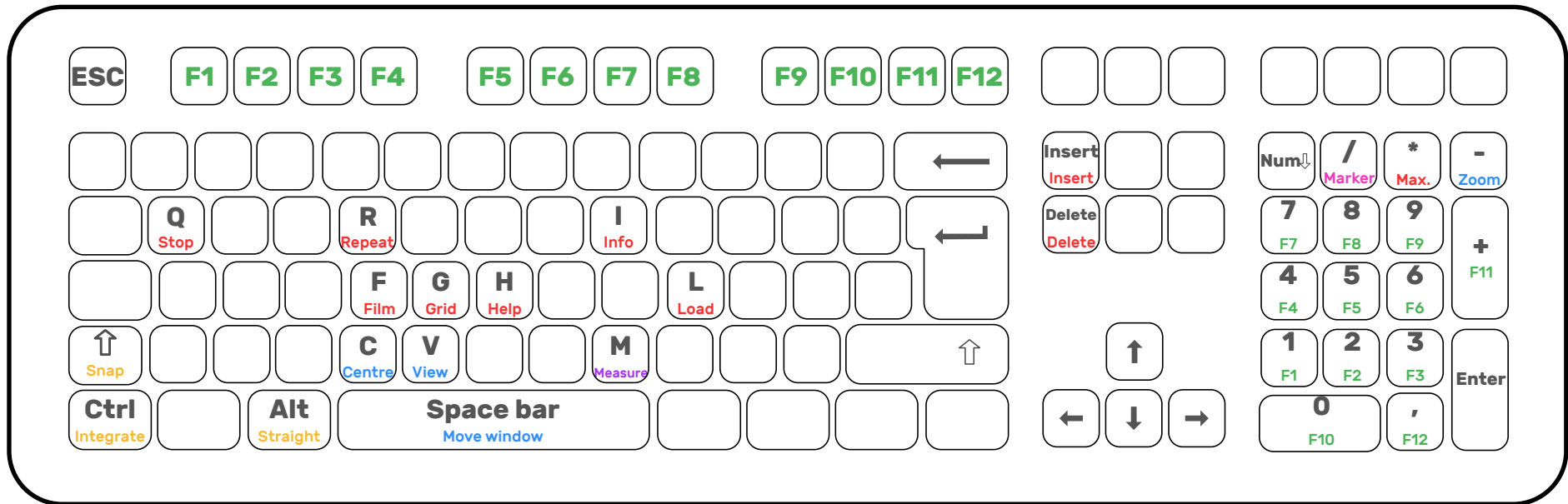

Shift	
Ctrl	
Alt	
Alt + Shift	

C	
V	
Space bar	
- (*)	

/ (*)	
-------	--

M	
---	--

Q	
R	
F	
G	
H	
L	
* (*)	

(*) These keys are located on the number pad of the keyboard. To use them, NumLock must be switched on.